

Powder Coating

Powder Coatings are formulated in a multitude of colours, lustres, textures and “special-effect” finishes. Owing to this great range of colour and finish options, they are an extremely versatile and are a popular choice for architectural projects all over the world.

Which finish is right for your project?

1. Consider the right Type of Finish for your project application
 (E.g. Anodising or Powder Coat) Refer to “[Selecting Suitable Finishes](#)” webpage of our website for more information
2. Select a Grade of Finish that is able to deliver your requirements
 (E.g. Standard Durability or High Durability finishes. Consider the local environmental conditions and level of performance expected over the lifetime of your project. Is a performance warranty required?)
3. Select a Colour & Lustre of finish that provides the “look” you want
 Use [AAF’s Colour Selector](#) Tool to help you find the look you want



Do some colours offer better appearance than others?

Yes. Upon handling in fabrication, installation and ultimate use, any scuffs, mar, dust, or even minute imperfections such as die lines on the base metal can be evident on your finished metal surface. Lower gloss finishes diffuse light in many directions, rather than directly reflecting it. This phenomenon has the tendency to diminish rather than highlight the appearance of any aberrations on the surface.

Generally speaking, if you want to diminish the appearance of any aberrations, choose;

- A Lighter rather than Darker shade of colour
- A Lustre that is Lower in Gloss level

e.g.
 Classic Cream Low Sheen,
 Lower gloss = Less reflective,
 Any aberrations are less noticeable



15-40%
Matt/Low Sheen

Gloss Black,
 Higher Gloss = More reflective,
 Any aberrations are more noticeable



45-65%
Satin

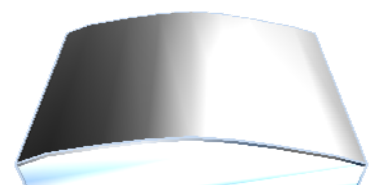

80-95%
Gloss/Bright

Is there a range of colours that are easy to handle as well as look good on the final job?

Bearing the above in mind, the colour selections offered in the Colorbond® range of colours are an ideal choice for standard Residential and Commercial Building Projects. These popular colours are widely used in the building industry, so ability to “mix ‘n match” becomes so easy! Yet the selection is distinctive enough to provide a generous palette of colours to compliment the final appeal of your product and project.



Is there a range of Standard Industry Colours that are commonly used?

Over the years, there are a number of colours which have consistently become popular picks. These listed below are time-tested popular colours which compliment many architectural applications. Being the popular choices, these colours are also usually the most economically priced.



Note:

The colours depicted above are a guide only. They are not intended to be used for colour matching or selection purposes. COLORBOND® is a registered trademark of BlueScope Steel Limited.

What are the current colour trends in powder coating?

The colours that have been popular of late have tended to be either Metallic in appearance or at least compliment other natural building materials such as timber, stone, metal and glass. Now more than ever before, there are many offerings for Metallic and Pearlescent effect colours. Just refer to the AAF colour selector  to be able to locate the Metallic / Pearl colours on offer.



Why Choose Higher Grade Super & Ultra-Durable Powders?

Super Durable and Ultra Durable powders are also available for your project. These powders are formulated with higher grade polymers and pigments, which provide better weathering (colour and gloss) than the standard powder coatings. This means that your finish can look newer for longer! Some colours and grades of these high grade powders are available off the shelf, whilst the remainder can be Made-to-Order (MTO).

Given our harsh UV conditions, it's not unreasonable to understand why the Australian Architectural marketplace is one of the highest users of High-grade powders. It's also important to note that only registered applicators are licensed to be able to apply these higher-grade coatings. AAF is licensed to apply all the Interpon and Dulux High grade Powder coatings which include;

Dulux: Duratec, Duratec LX & Fluoraset FP

Interpon: D2010, 2015 & D3000 Fluoromax

Benefits of warranty grade coatings over standard grade coatings;

- Higher grade pigments and resins are used in the formulation, so colours will resist weathering better than standard colours and your project looks newer for much longer.
- The finish is proven to perform at a higher level in a given environment, so they can be warranted from 10-20 years.
- Given their extended level of performance, they provide better long term value for money.

Are there other things I should be looking out for?

Yes, it's a good idea that you ensure that;

- The correct finish is specified for your product / project
- Any cut-ends and drilled/punched holes are appropriately sealed in fabrication
- Design/Fabrication provides appropriate drainage
- In order to reduce risk of galvanic reactions/corrosion, use correct fixing screws and avoiding direct contact with dissimilar metals.
- On site, finished aluminium products have appropriate preventative protective films
- Care & Maintenance at regular intervals; The AAF recommended maintenance procedure (TB 100 – “The Basics of Aluminium Care”) is available from our website www.aafonline.com.au)

Note

Details contained herewith do not constitute specific advice, merely they are provided as a matter of courtesy and as general information only. Reference should also be made to Australian Aluminium Finishing Pty Ltd (AAF) Terms and Conditions of Sale as well as latest releases of the relevant Australian Standard for the finish concerned are available for purchase via the following website; <http://www.saiglobal.com/shop>

AAF makes no warranty as to the completeness, accuracy or reliability of any information expressed or contained in this document, and to the full extent permitted by law, AAF disclaims all liability and responsibility for any loss or damage, direct or indirect, which may be suffered by any persons acting in reliance on anything contained or omitted from this document.